



## STRUCTURAL SCREWS

### MS24694

#### PHILLIPS 100 DEG FLAT HEAD

MATERIAL - (S) ALLOY STEEL PER MIL-S-6049 (8740)  
 (C) CRES STEEL PER FED-STD-66 (300 SERIES)  
 HEAT TREAT - ALLOY STEEL, 125-145KSI PER AMS2759  
 HARDNESS C26-C32  
 FINISH - ALLOY STEEL, CAD PER QQ-P-416 TYPE II, CLASS 3  
 CRES, PASSIVATE PER QQ-P-35

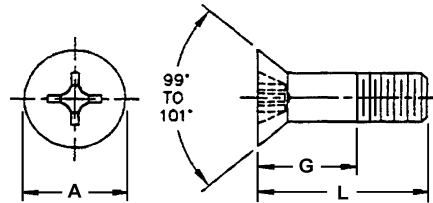

MS24694S



MS24694C

THREAD	8-32			10-32			1/4-28		
A	.283 - .332			.327 - .385			.447 - .507		
TENSILE LBS/MIN	1750	1190		2500	1700		4550	3090	
L	DASH		G	DASH		G	DASH		G
	ALLOY	CRES		ALLOY	CRES		ALLOY	CRES	
0.281	S1	C1	0.094	S46	C46	0.109	-	-	-
0.344	S2	C2	0.094	S47	C47	0.109	-	-	-
0.406	S3	C3	0.094	S48	C48	0.109	S93	-	0.141
0.469	S4	C4	0.094	S49	C49	0.109	S94	C94	0.141
0.531	S5	C5	0.094	S50	C50	0.109	S95	C95	0.141
0.594	S6	C6	0.156	S51	C51	0.109	S96	C96	0.141
0.656	S7	C7	0.219	S52	C52	0.187	S97	C97	0.141
0.719	S8	C8	0.281	S53	C53	0.250	S98	C98	0.188
0.781	S9	C9	0.344	S54	C54	0.312	S99	C99	0.250
0.844	10	C10	0.406	S55	C55	0.375	S100	-	0.312
0.906	S11	C11	0.469	S56	C56	0.438	S101	C101	0.375
0.969	S12	-	0.531	S57	C57	0.500	S102	-	0.438
1.031	S13	C13	0.594	S58	C58	0.563	S103	-	0.500
1.094	S14	-	0.656	S59	C59	0.625	S104	-	0.563
1.156	S15	-	0.719	S60	C60	0.688	S105	-	0.625
1.219	S16	-	0.781	S61	C61	0.750	S106	-	0.688
1.281	S17	-	0.844	S62	C62	0.813	S107	-	0.750
1.344	S18	-	0.906	S63	C63	0.875	S108	-	0.813
1.406	S19	-	0.969	S64	C64	0.938	S109	-	0.875
1.469	S20	-	1.031	S65	C65	1.000	S110	-	0.938
1.531	S21	-	1.094	S66	C66	1.062	S111	-	1.000
1.594	-	-	1.156	S67	-	1.125	S112	-	1.062
1.656	S23	-	1.219	S68	-	1.188	S113	-	1.125
1.719	-	-	1.281	S69	-	1.250	S114	-	1.188
1.781	S25	-	1.344	S70	-	1.312	S115	-	1.250
1.844	-	-	1.406	S71	-	1.375	S116	-	1.312
1.906	-	-	1.469	S72	-	1.438	S117	-	1.375
1.969	-	-	1.531	-	-	1.500	S118	-	1.438
2.031	S29	-	1.594	S74	-	1.563	S119	-	1.500
2.094	-	-	-	S75	-	1.625	-	-	1.563
2.156	-	-	-	S76	-	1.688	S121	-	1.625
2.219	-	-	-	S77	-	1.750	-	-	1.688
2.281	-	-	-	-	-	1.813	S123	-	1.750
2.344	-	-	-	S79	-	1.875	-	-	-
2.406	-	-	-	S80	-	1.938	-	-	-
2.531	-	-	-	S82	-	2.063	-	-	-
2.656	-	-	-	S84	-	2.188	-	-	-
3.031	-	-	-	S90	-	2.563	-	-	-