

MACHINE SCREWS

MS24693S

PHILLIPS 100 DEG FLAT HEAD

MATERIAL - CARBON STEEL PER FED-STD-66
FINISH - CADMIUM PER QQ-P-416, TYPE II

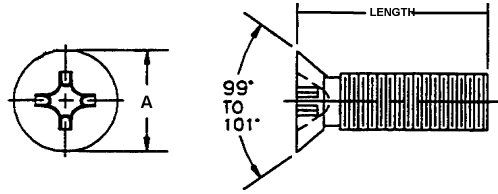

MS24693C / NAS662C

PHILLIPS 100 DEG FLAT HEAD

MATERIAL - 300 SERIES STAINLESS STEEL
FINISH - PASSIVATE PER ASTM A380



MS24693S

MS24693					
THREAD	4-40	6-32	8-32	10-32	1/4-28
A	0.207	0.257	0.308	0.359	0.477
TENSILE LBS/MIN	360	545	840	1200	2180
LENGTH	DASH#	DASH#	DASH#	DASH#	DASH#
0.188	S1	S23	-	-	-
0.250	S2	S24	S46	S268	-
0.312	S3	S25	S47	S269	-
0.375	S4	S26	S48	S270	-
0.438	S5	S27	S49	S271	S293
0.500	S6	S28	S50	S272	S294
0.625	S7	S29	S51	S273	S295
0.750	S8	S30	S52	S274	S296
0.875	S9	S31	S53	S275	S297
1.000	S10	S32	S54	S276	S298
1.125	S11	S33	S55	S277	-
1.250	S12	S34	S56	S278	-
1.375	-	-	-	S279	-
1.500	S14	S36	S58	S280	-
1.625	-	-	-	S281	-
1.750	-	-	-	S282	-
2.000	-	S40	S62	S284	-
2.500	-	-	S64	S286	-
3.000	-	-	S66	S288	-



MS24693C / NAS662C

		NAS662	MS24693				
THREAD		2-56	4-40	6-32	8-32	10-32	1/4-28
A		0.156	0.207	0.257	0.308	0.359	0.477
TENSILE LBS/MIN		295	480	725	1120	1600	2910
LENGTH	DASH#	DASH#	DASH#	DASH#	DASH#	DASH#	DASH#
0.125	C2R2	-	-	-	-	-	-
0.188	C2R3	C1	C23	-	-	-	-
0.250	C2R4	C2	C24	C46	C268	-	-
0.312	C2R5	C3	C25	C47	C269	-	-
0.375	C2R6	C4	C26	C48	C270	-	-
0.438	C2R7	C5	C27	C49	C271	C293	-
0.500	-	C6	C28	C50	C272	C294	-
0.625	-	C7	C29	C51	C273	C295	-
0.750	-	C8	C30	C52	C274	C296	-
0.875	-	C9	C31	C53	C275	-	-
1.000	-	C10	C32	C54	C276	C298	-
1.125	-	-	C33	C55	C277	-	-
1.250	-	-	C34	C56	C278	-	-
1.375	-	-	-	-	C279	-	-
1.500	-	-	-	C58	C280	-	-
1.750	-	-	-	C60	C282	-	-
2.000	-	-	-	C62	C284	-	-
2.250	-	-	-	C64	C286	-	-