

### SPEED NUTS - FLAT TYPE

MATERIAL - SPRING STEEL  
 FINISH - PHOSPHATE PLUS OLIVE DRAB PAINT

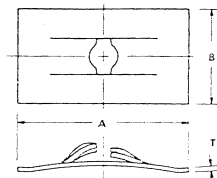

PART NUMBER	TYPE B SCREW SIZE	A LENGTH	B WIDTH	T MATERIAL THICKNESS
A1776-4Z1D	#4	0.500	0.310	0.022
A1777-6Z1D	#6	0.630	0.440	0.025
A1778-8Z1D	#8	0.630	0.440	0.028
A1779-10Z1D	#10	0.880	0.500	0.028

### SPEED NUTS - ANCHOR TYPE

MATERIAL - SPRING STEEL  
 FINISH - PHOSPHATE PLUS OLIVE DRAB PAINT

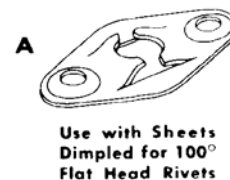
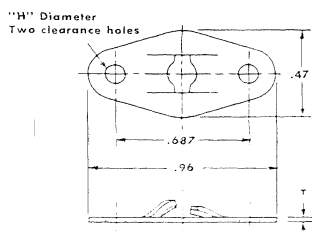

PART NUMBER	TYPE B SCREW SIZE	DESIGN VARIATION	H HOLE DIAMETER	T MATERIAL THICKNESS
A6191-6Z1D	#6	-	0.105	0.025
A6191-8Z1D	#8	-	0.105	0.028
A6195-6Z1D	#6	A	0.105	0.025
A6195-8Z1D	#8	A	0.105	0.028