

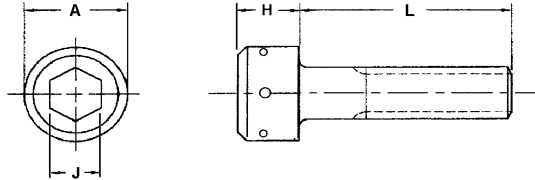

## SOCKET CAP SCREWS - STAINLESS STEEL

### MS16995 / MS16996 SOCKET HEAD CAP SCREW

MATERIAL - CRES, 300 SERIES PER FF-S-86  
FINISH - PASSIVATE PER AMS2700



UNDRILLED

THREAD	MS16995			MS16996	
	4-40	6-32	8-32	10-32	1/4-28
A	0.183	0.226	0.270	0.312	0.375
H	0.109	0.138	0.164	0.190	0.250
J	0.094	0.109	0.141	0.156	0.188
MIN BREAKING STRENGTH (LBS)	480	730	1120	1600	2910
LENGTH (L)	DASH#	DASH#	DASH#	DASH#	DASH#
0.250	9	16	-	-	-
0.375	10	17	25	9	-
0.500	11	18	26	10	21
0.625	12	19	27	11	22
0.750	13	20	28	12	23
0.875	-	-	29	13	-
1.000	-	21	30	14	24
1.250	-	-	-	15	25
1.500	-	-	-	-	26

### MS24673 / MS24674 SOCKET HEAD CAP SCREW

MATERIAL - CRES, 300 SERIES PER FF-S-86  
FINISH - PASSIVATE PER AMS2700



DRILLED

THREAD	MS24674			MS24673	
	4-40	6-32	8-32	10-32	1/4-28
A	0.183	0.226	0.270	0.312	0.375
H	0.109	0.138	0.164	0.190	0.250
J	0.094	0.109	0.141	0.156	0.188
DRILLED HOLE	0.033	0.033	0.044	0.044	0.044
MIN BREAKING STRENGTH (LBS)	480	730	1120	1600	2910
LENGTH	DASH#	DASH#	DASH#	DASH#	DASH#
0.250	-	1	6	-	-
0.375	-	2	7	1	-
0.500	-	3	8	2	9
0.625	-	-	9	3	10
0.750	-	-	-	4	11
0.875	-	-	-	-	-
1.000	-	-	-	-	12