

## SELF LOCKING NUTS

### MS20500 HEX, HIGH TEMPERATURE

MATERIAL - HEAT & CORROSION RESISTING STEEL  
FINISH - SILVER PLATE PER AMS2410

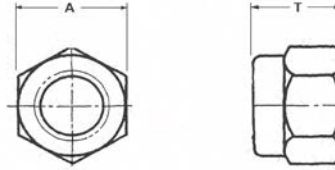

DASH #	THREAD SIZE	A DIM	T DIM	AXIAL STRENGTH LBS/MIN
1032	10-32	.367 - .376	.202 - .250	2460
428	1/4-28	.430 - .439	.280 - .328	4580
524	5/16-24	.492 - .502	.312 - .360	7390
624	3/8-24	.553 - .564	.421 - .469	11450

### MS20364 (C) HEX, THIN (ALL METAL)

MATERIAL - ALLOY STEEL  
FINISH - CAD TYPE II PER QQ-P-416

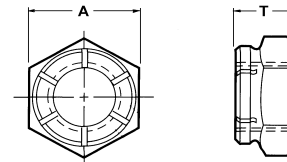

DASH #	THREAD SIZE	A DIM	T DIM	AXIAL STRENGTH LBS/MIN
632C	6-32	0.312	0.125	1270
832C	8-32	0.344	0.172	1960
1032C	10-32	0.375	0.172	2800
428C	1/4-28	0.438	0.203	5090
524C	5/16-24	0.500	0.250	5510
624C	3/8-24	0.563	0.266	8340

### MS17830 HEX, NYLON INSERT

MATERIAL - 300 SERIES STAINLESS STEEL  
FINISH - PASSIVATE PER ASTM A967

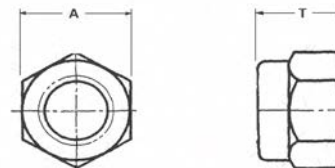

DASH #	THREAD SIZE	A DIM	T DIM	AXIAL STRENGTH LBS/MIN
08C	8-32	.336 - .345	.219 - .281	1750
010C	10-24	.367 - .376	.208 - .281	2190
4C	1/4-20	.430 - .439	.240 - .360	3980
5C	5/16-18	.492 - .502	.271 - .360	6550
6C	3/8-16	.553 - .564	.318 - .469	9690