

## TAPPING & DRIVE SCREWS

### NAS548

PHILLIPS 100 DEG. FLAT HEAD, TYPE B POINT

MATERIAL - HARDENED STEEL PER FF-S-107 TYPE 1016,  
1018, 1019, 1021, 1022 OR 1024  
FINISH - CADMIUM PER QQ-P-416 TYPE I

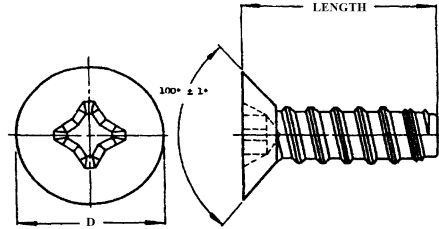

SIZE	#6	#8	#10
D	.249 - .279	.300 - .322	.348 - .385
LENGTH	DASH #	DASH #	DASH #
3/8	P6-6	P8-6	P10-6
1/2	P6-8	P8-8	P10-8
5/8	P6-10	P8-10	P10-10
3/4	P6-12	P8-12	P10-12

### MS21318

ROUND HEAD U-DRIVE

MATERIAL - HARDENED STEEL PER FF-S-107 TYPE 1016,  
1018, 1019, 1021, 1022 OR 1024  
FINISH: CADMIUM PER QQ-P-416 TYPE II, CLASS 3

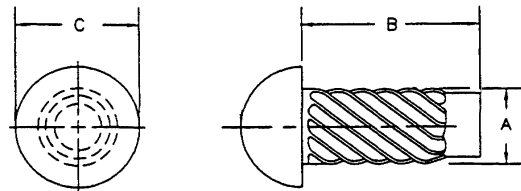

SIZE	#00	#0	#2	#4	#6
A	.057 - .060	.072 - .075	.097 - .100	.112 - .116	.136 - .140
C	.090 - .099	.118 - .127	.146 - .162	.193 - .211	.240 - .260
HOLE SIZE	0.052	0.067	0.086	0.104	0.120
DRILL SIZE	55	51	44	37	31
LENGTH B	DASH #	DASH #	DASH #	DASH #	DASH #
1/8	1	7	13	-	-
3/16	2	8	14	20	-
1/4	-	9	15	21	27
5/16	-	-	-	22	-
3/8	-	-	-	-	29