

LOCKWASHERS - NYLON WASHERS

MS35338

HELICAL SPRING

MATERIAL: CARBON STEEL, 1060-1080
CORROSION RESISTANT STL 300 SERIES / 316

FINISH: CARBON STEEL - CADMIUM PER QQ-P-416 TYPE II
OR MIL-C-81562 TYPE II, OR ZINC PER MIL-C-82562
CRES - PASSIVATE PER QQ-P-35

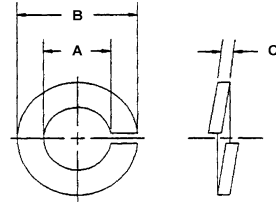

STEEL



CRES

STEEL DASH#	CRES DASH#	SIZE	A	B MAX	C MIN
39	134	2	0.091	0.172	0.020
40	135	4	0.117	0.209	0.025
41	136	6	0.145	0.250	0.031
42	137	8	0.171	0.293	0.040
43	138	10	0.197	0.334	0.047
44	139	1/4	0.256	0.487	0.062
45	140	5/16	0.318	0.583	0.078
46	141	3/8	0.381	0.680	0.094
47	142	7/16	0.445	0.776	0.109
48	143	1/2	0.507	0.869	0.125

NAS1515

FLAT

MATERIAL: L-P-410 NYLON 6/6
FINISH: PLAIN

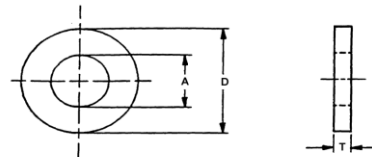

DASH#	SIZE	A	D	T
H04L	4	0.125	0.312	0.031
H06L	6	0.149	0.375	
H08L	8	0.174	0.375	
H3L	10	0.203	0.438	