

## TENSION BOLTS

### NAS6203 / NAS6204 HEX HEAD, SHORT THREAD

MATERIAL - ALLOY STEEL, 4140 (AMS6549)  
4340 (AMS6415) OR 8740 (AMS6322)  
FINISH - CADMIUM PER AMS-QQ-P-416 TYPE II, CLASS 2  
HEAT TREAT - 160-180 KSI PER AMS2759  
HARDNESS - HRC36-40

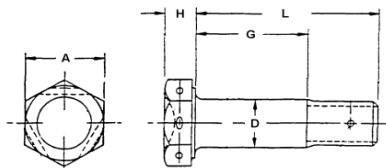

<b>NAS6203</b>		A = .376 D = .1885-.1895 H = .110		
THREAD:		10-32 UNJF-3A		
TENSILE:		3620 LBS. MIN		
SHEAR:		5380 LBS. MIN		
G	L	UN DRILLED	SHANK DRILLED	HEAD DRILLED
GRIP	LGTH		0.075	0.046
		DASH#	DASH#	DASH#
0.0625	0.3855	1	1D	1H
0.1250	0.4480	2	2D	2H
0.1875	0.5105	3	3D	3H
0.2500	0.5730	4	4D	4H
0.3125	0.6355	5	5D	5H
0.3750	0.6980	6	6D	6H
0.4375	0.7605	7	7D	7H
0.5000	0.8230	8	8D	8H
0.5625	0.8855	9	9D	9H
0.6250	0.9480	10	10D	10H
0.6875	1.0105	11	11D	11H
0.7500	1.0730	12	12D	12H
0.8125	1.1355	13	13D	13H
0.8750	1.1980	14	14D	14H
0.9375	1.2605	15	15D	15H
1.0000	1.3230	16	16D	16H
1.0625	1.3855	17	17D	17H
1.1250	1.4480	18	18D	18H
1.1875	1.5105	19	19D	19H
1.2500	1.5730	20	20D	20H
1.3125	1.6355	21	21D	21H
1.3750	1.6980	22	22D	22H
1.4375	1.7605	23	23D	23H
1.5000	1.8230	24	24D	24H
1.5625	1.8855	25	25D	25H
1.6250	1.9480	26	26D	26H
1.6875	2.0105	27	27D	27H
1.7500	2.0730	28	28D	28H
1.8125	2.1355	29	29D	29H
1.8750	2.1980	30	30D	30H
1.9375	2.2605	31	31D	31H
2.0000	2.3230	32	32D	32H
2.1250	2.4480	34	34D	34H
2.2500	2.5730	36	36D	36H

<b>NAS6204</b>		A = .439 D = .2485-.2495 H = .125		
THREAD:		1/4-28 UNJF-3A		
TENSILE:		6470 LBS. MIN		
SHEAR:		9300 LBS. MIN		
G	L	UN DRILLED	SHANK DRILLED	HEAD DRILLED
GRIP	LGTH		0.081	0.046
		DASH#	DASH#	DASH#
0.0625	0.4325	1	1D	1H
0.1250	0.4950	2	2D	2H
0.1875	0.5575	3	3D	3H
0.2500	0.6200	4	4D	4H
0.3125	0.6825	5	5D	5H
0.3750	0.7450	6	6D	6H
0.4375	0.8075	7	7D	7H
0.5000	0.8700	8	8D	8H
0.5625	0.9325	9	9D	9H
0.6250	0.9950	10	10D	10H
0.6875	1.0575	11	11D	11H
0.7500	1.1200	12	12D	12H
0.8125	1.1825	13	13D	13H
0.8750	1.2450	14	14D	14H
0.9375	1.3075	15	15D	15H
1.0000	1.3700	16	16D	16H
1.0625	1.4325	17	17D	17H
1.1250	1.4950	18	18D	18H
1.1875	1.5575	19	19D	19H
1.2500	1.6200	20	20D	20H
1.3125	1.6825	21	21D	21H
1.3750	1.7450	22	22D	22H
1.4375	1.8075	23	23D	23H
1.5000	1.8700	24	24D	24H
1.5625	1.9325	25	25D	25H
1.6250	1.9950	26	26D	26H
1.6875	2.0575	27	27D	27H
1.7500	2.1200	28	28D	28H
1.8125	2.1825	29	29D	29H
1.8750	2.2450	30	30D	30H
1.9375	2.3075	31	31D	31H
2.0000	2.3700	32	32D	32H
2.1250	2.4950	34	34D	34H
2.2500	2.6200	36	36D	36H

## TENSION BOLTS

### NAS6205 / NAS6206 HEX HEAD, SHORT THREAD

MATERIAL - ALLOY STEEL, 4140 (AMS6549)  
4340 (AMS6415) OR 8740 (AMS6322)  
FINISH - CADMIUM PER AMS-QQ-P-416 TYPE II, CLASS 2  
HEAT TREAT - 160-180 KSI PER AMS2759  
HARDNESS - HRC36-40

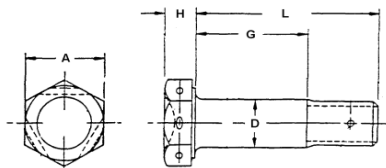

<b>NAS6205</b>		A = .502 D = .3110-.3120 H = .156		
THREAD:		5/16-24 UNJF-3A		
TENSILE:		10200 LBS. MIN		
SHEAR:		14600 LBS. MIN		
G	L	UN DRILLED	SHANK DRILLED	HEAD DRILLED
GRIP	LGTH		0.081	0.080
		DASH#	DASH#	DASH#
0.0625	0.5005	1	1D	1H
0.1250	0.5630	2	2D	2H
0.1875	0.6255	3	3D	3H
0.2500	0.6880	4	4D	4H
0.3125	0.7505	5	5D	5H
0.3750	0.8130	6	6D	6H
0.4375	0.8755	7	7D	7H
0.5000	0.9380	8	8D	8H
0.5625	1.0005	9	9D	9H
0.6250	1.0630	10	10D	10H
0.6875	1.1255	11	11D	11H
0.7500	1.1880	12	12D	12H
0.8125	1.2505	13	13D	13H
0.8750	1.3130	14	14D	14H
0.9375	1.3755	15	15D	15H
1.0000	1.4380	16	16D	16H
1.0625	1.5005	17	17D	17H
1.1250	1.5630	18	18D	18H
1.1875	1.6255	19	19D	19H
1.2500	1.6880	20	20D	20H
1.3125	1.7505	21	21D	21H
1.3750	1.8130	22	22D	22H
1.4375	1.8755	23	23D	23H
1.5000	1.9380	24	24D	24H
1.5625	2.0005	25	25D	25H
1.6250	2.0630	26	26D	26H
1.6875	2.1255	27	27D	27H
1.7500	2.1880	28	28D	28H
1.8125	2.2505	29	29D	29H
1.8750	2.3130	30	30D	30H
1.9375	2.3755	31	31D	31H
2.0000	2.4380	32	32D	32H
2.1250	2.5630	34	34D	34H
2.2500	2.6880	36	36D	36H

<b>NAS6206</b>		A = .564 D = .3735-.3745 H = .188		
THREAD:		3/8-24 UNJF-3A		
TENSILE:		15200 LBS. MIN		
SHEAR:		21000 LBS. MIN		
G	L	UN DRILLED	SHANK DRILLED	HEAD DRILLED
GRIP	LGTH		0.111	0.080
		DASH#	DASH#	DASH#
0.0625	0.5165	1	1D	1H
0.1250	0.5790	2	2D	2H
0.1875	0.6415	3	3D	3H
0.2500	0.7040	4	4D	4H
0.3125	0.7665	5	5D	5H
0.3750	0.8290	6	6D	6H
0.4375	0.8915	7	7D	7H
0.5000	0.9540	8	8D	8H
0.5625	1.0165	9	9D	9H
0.6250	1.0790	10	10D	10H
0.6875	1.1415	11	11D	11H
0.7500	1.2040	12	12D	12H
0.8125	1.2665	13	13D	13H
0.8750	1.3290	14	14D	14H
0.9375	1.3915	15	15D	15H
1.0000	1.4540	16	16D	16H
1.0625	1.5165	17	17D	17H
1.1250	1.5790	18	18D	18H
1.1875	1.6415	19	19D	19H
1.2500	1.7040	20	20D	20H
1.3125	1.7665	21	21D	21H
1.3750	1.8290	22	22D	22H
1.4375	1.8915	23	23D	23H
1.5000	1.9540	24	24D	24H
1.5625	2.0165	25	25D	25H
1.6250	2.0790	26	26D	26H
1.6875	2.1415	27	27D	27H
1.7500	2.2040	28	28D	28H
1.8125	2.2665	29	29D	29H
1.8750	2.3290	30	30D	30H
1.9375	2.3915	31	31D	31H
2.0000	2.4540	32	32D	32H
2.1250	2.5790	34	34D	34H
2.2500	2.7040	36	36D	36H